

NOTE

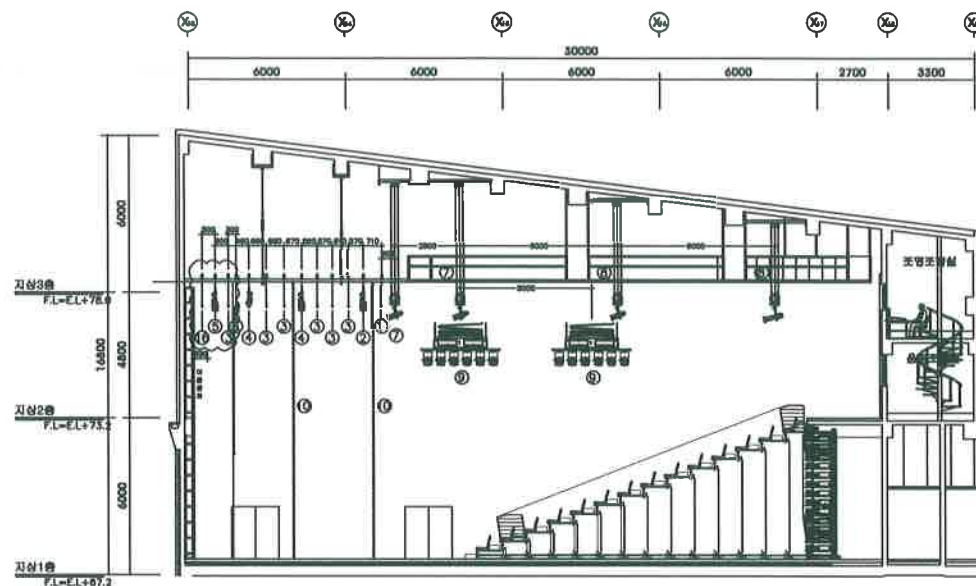

SYSTEM EQUIPMENT LIST

NO	DESCRIPTION	SPECIFICATION	QUANTITY		CIRCUIT			MACHINE CAPACITY(kw)	LIGHT CAPACITY(kw)	REMARKS
			원장량	변경량	DISMNO	REMOTE DIRECT	DIRECT			
①	REARWARD BATTEN	12,000L (1.5kw X 4P)	1 SET	1 SET				1.5		
②④	NO.1~3 SUSPENSION LIGHT BATTEN	12,000L (2.2kw X 4P)	2 SET	3 SET				4.4		SUSPENSION LIGHT BATTEN (1SET 8P), LIVE LOAD 7500
③	FLY DUCT	C-TYPE 30A X 45 OUTLET L=12,000	2 SET	2 SET	7/4	7/2				
⑤	NO.1~6 SET BATTEN	12,000L (3.75kw X 4P)	5 SET	6 SET				18.75		SET BATTEN (1SET 추가)
⑥	UPPER LIGHT BATTEN	12,000L (2.2kw X 4P)	1 SET	1 SET				2.2		
	UPPER LIGHT FLY DUCT	C-TYPE 30A X 40 OUTLET L=12,000	1 SET	1 SET	10					
	UPPER LIGHT	HL 500W	40 SET	40 SET					20	
⑦	FLAG BATTEN(이동스크린)	12,000L (1.5kw X 4P)	1 SET	1 SET				1.5		
⑧	NO.1~4 DRIVING LIFT	3,000L (HDL-150, 1.5kw X 4P).XLR	5pl4 SET	4 SET	2/8	1/4		6		
⑨	NO.5~8 DRIVING LIFT	3,000L (HDL-150, 1.5kw X 4P)	2 SET	2 SET	3/6			3		
⑩	NO.9~12 DRIVING LIFT	3,000L (HDL-150, 1.5kw X 4P)	6 SET	6 SET	3/18			9		
⑪	NO.1~2 LEG CURTAIN	3,300W X 10,500L (MANUAL)	2 SET	2 SET						
⑫	CONTROL CONSOLE	HT-15C	1 SET	1 SET						
⑬	CONNECTOR BOX		1 SET	1 SET						
⑭	CONTROL PANEL	MAIN / M 20CCT / R.D 6CIR	1 SET	1 SET						
	조명식 부대(설계 변경으로 삭제)	2,400W X 1,200D	20 SET	20 SET						
⑮	CONNECTOR BOX		2 SET	2 SET						
⑯	WALL POCKET	30A, 3P X 3EA	2 SET	2 SET	4	2		6		
⑰	DOWN LIGHT (정광형)	HL 500W	6 SET	6 SET			1		3	
⑱	HORIZONTAL BATTEN	12,000L (EHW45, 1.5kw X 4P)	1 SET					1.5		신설
	FRONT SCREEN (현관광자판)									
	HOUSE & SPARE				12&24					
	TOTAL				98	8	1	42.6	29	MACHINE MCCB 50AF/50AT
	DEMAND FACTOR							50%	80%	MAIN MCCB 225AF/200AT

NO. 100 DESCRIPTION 148 DATE 2018/01/10 APPROV. 1000

REVISIONS

APPROVED

PROJECT TITLE: 서울특별시

품의물아르선터 무대기계장치
구매 및 설치

SUB TITLE

NAME OF DRAWING: 도면명

무대장치 단면도(파포먼스홀)

DATE: 일자

2018/01/

SCALE: 축척

A1: 1/100

A3: 1/200

DRAWN BY: 원도

APPROVED BY: 승인

DRAWING NO.: 도면번호

01-0001

NOTE

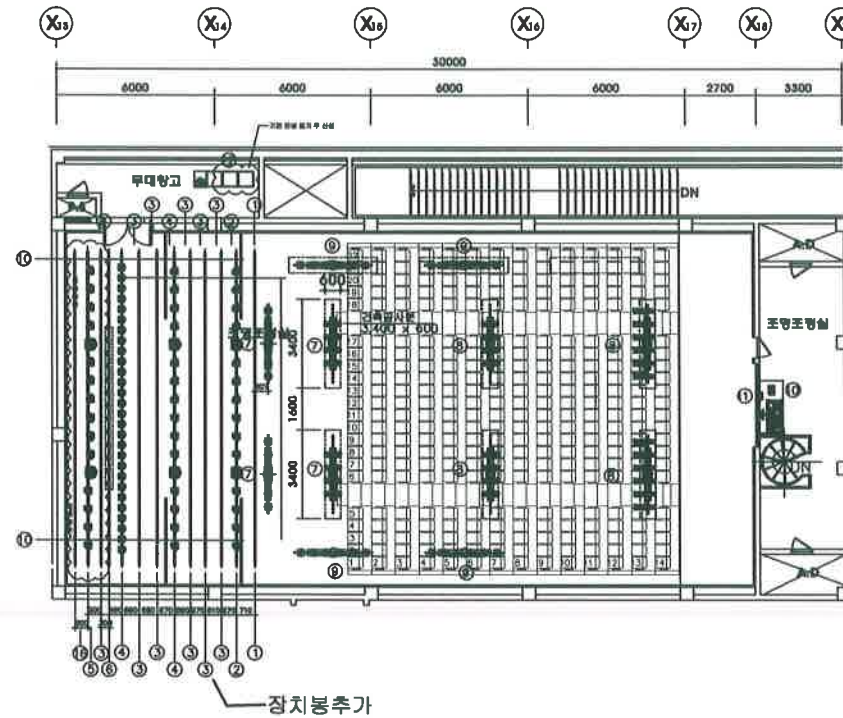
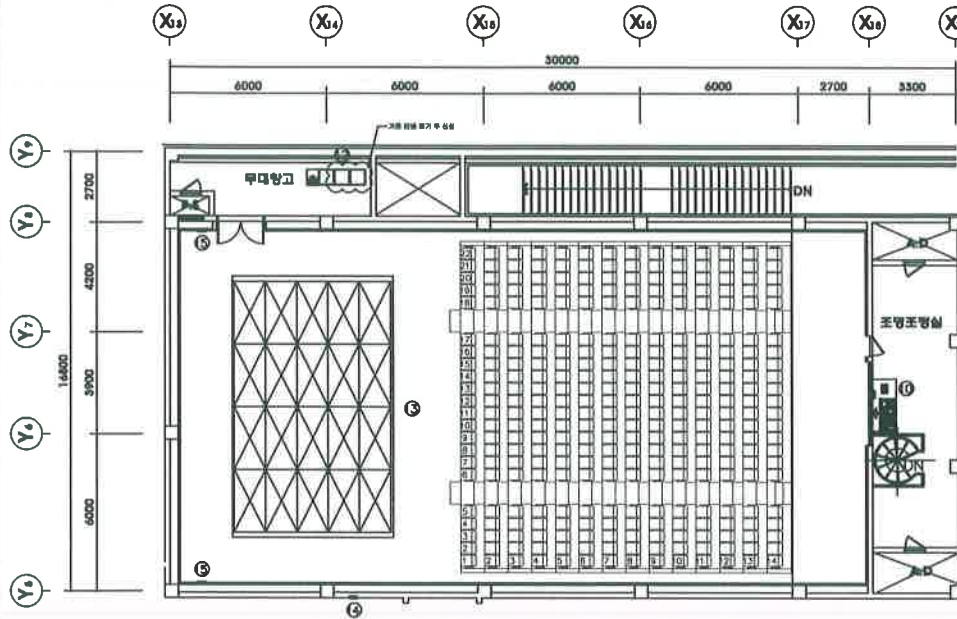

SYSTEM EQUIPMENT LIST							
NO	DESCRIPTION	SPECIFICATION	QUANTITY	CIRCUIT			REMARKS
			변경전	DIMMING	REMOTE DIRECT	DIRECT	
①	REAR BOARD BATTEN	12,000L (1.5kw X 4P)	1 SET	1 SET			
②④	NO.1~2 SUSPENSION LIGHT BATTEN	12,000L (2.2kw X 4P)	2 SET	3 SET			SUSPENSION LIGHT BATTEN (1SET 추가), LIVE LOAD 7000D
③	NO.1~5 SET BATTEN	12,000L (3.75kw X 4P)	5 SET	6 SET			SET BATTEN (1SET 추가)
⑤	UPPER LIGHT BATTEN	12,000L (2.2kw X 4P)	1 SET	1 SET			
	UPPER LIGHT FLY DUCT	C-TYPE 30A x 40 OUTLET L=12,000	1 SET	1 SET	10		
	UPPER LIGHT	HL 500W	40 SET	40 SET			20
⑥	FLAG BATTEN (이동스크림)	12,000L (1.5kw X 4P)	1 SET	1 SET			1.5
⑦	NO.1~4 DRIVING LIFT	3,000L (HDL-150, 1.5kw X 4P), XLR	5 SET	4 SET	2/8	1/4	8
⑧	NO.5~8 DRIVING LIFT	3,000L (HDL-150, 1.5kw X 4P)	2 SET	2 SET	3/6		3
⑨	NO.9~12 DRIVING LIFT	3,000L (HDL-150, 1.5kw X 4P)	8 SET	6 SET	3/18		9
⑩	NO.1~2 LEG CURTAIN	3,300W x 10,500L (MANUAL)	2 SET	2 SET			
⑪	CONTROL CONSOLE	HT-15C	1 SET	1 SET			
⑫	CONNECTOR BOX		1 SET	1 SET			
⑬	CONTROL PANEL	MAIN / M 20CCT / R.D 6CIR	1 SET	1 SET			
⑭	조명식 무대(상기 변경으로 삭제)	2,400W X 1,200D	20 SET	20 SET			
⑮	CONNECTOR BOX		2 SET	2 SET			
⑯	WALL POCKET	30A.3P x 3EA	2 SET	2 SET	4	2	6
⑰	DOWN LIGHT (이동형)	HL 500W	8 SET	8 SET			3
⑱	HORIZONTAL BATTEN	12,000L (EHW45, 1.5kw X 4P)	1 SET				1.5
	HOLL-SYSTEM (동영상시스템)						
	HOUSE & SPARE			12&24			
	TOTAL			98	8	1	42.6
	DEMAND FACTOR						50%

무대장치 평면도(퍼포먼스용)

SCALE : 1/100

NO. 100 DESCRIPTION 148 DATE 2018/01/10 APPL. 0001

REVISIONS

Architect

PROJECT TITLE 사업명

공익시설아르헨티나 무대장치평면도
구매 및 설치

BUILD TITLE

NAME OF DRAWING 도면명

무대장치 평면도(퍼포먼스용)

DATE 일자 2018/01/

SCALE 축척 A1: 1/100 A3: 1/200

DRAWN BY 작성 APPROVED BY 승인

DRAWING NO. 도면번호

01F-002

NOTE

NO. DESCRIPTION 내용 DATE 날짜 APPL. 승인

REVISIONS

Annotations

PROJECT TITLE: 서명명

꿈의솔아르테센터 무대기계장치
구매 및 설치

DATE TITLE

NAME OF DRAWING: 도면명

PIPING & WIRING(퍼포먼스)

DATE 일자 2018/01/ DESIGNED BY 설계

SCALE: 축척 A1: 1/75 CHECKED BY 검사
A3: 1/150

DRAWN BY 제도 APPROVED BY 승인

DRAWING NO. 도면번호

01-0003

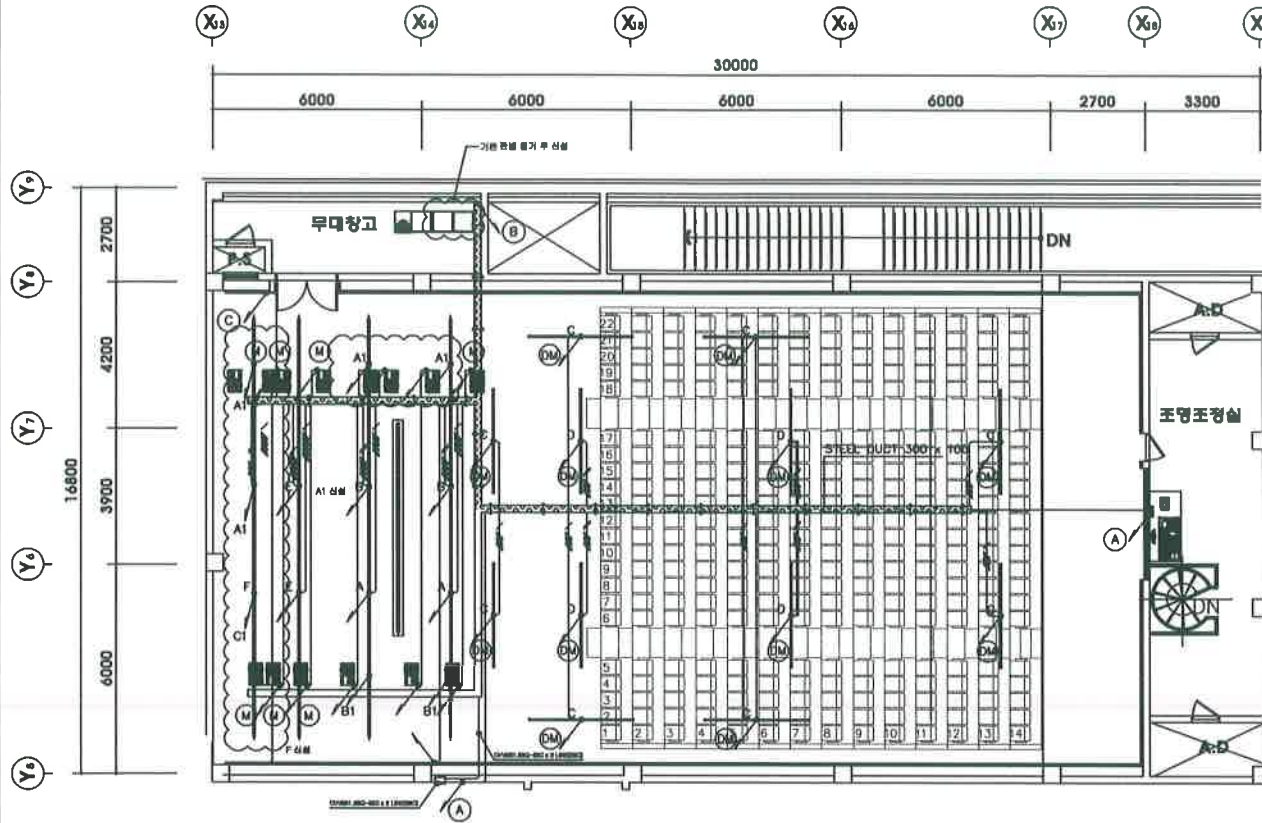

SYMBOL	DESCRIPTION
A	HIV8.0SQ x 10, E-FGV2.5SQ x 1 (36) FLAT CABLE 2RNC-T-F6.0SQ x 9C - 15M BELDEN CABLE #829 x 1LINE
A1	HIV8.0SQ x 10, E-FGV2.5SQ x 1 (36) FLAT CABLE 2RNC-T-F6.0SQ x 11C - 15M
B	HIV8.0SQ x 10, E-FGV2.5SQ x 1 (36) FLAT CABLE 2RNC-T-F6.0SQ x 9C - 15M
B1	HIV8.0SQ x 8, E-FGV2.5SQ x 1 (36) FLAT CABLE 2RNC-T-F6.0SQ x 9C - 15M
C	HIV4.0SQ x 6, E-FGV2.5SQ x 1 (36) FLAT CABLE VCT-F4.0SQ x 7C - 15M
C1	HIV6.0SQ x 8, E-FGV2.5SQ x 1 (36) FLAT CABLE VCT-F4.0SQ x 9C - 15M BELDEN CABLE #829 x 1LINE
D	HIV4.0SQ x 6, E-FGV2.5SQ x 1 (36) BELDEN CABLE #829 x 1LINE FLAT CABLE VCT-F4.0SQ x 7C - 15M FLAT BELDEN CABLE #829 x 1 - 15M
E	HIV4.0SQ x 10, E-FGV2.5SQ x 1 (36) FLAT CABLE VCT-F4.0SQ x 11C - 15M
F	HIV6.0SQ x 10, E-FGV2.5SQ x 1 (36) BELDEN CABLE #829 x 1LINE FLAT CABLE 2RNC-T-F6.0SQ x 11C - 15M
M	F-CV4.0? x 4C, F-CV1.5? x 3C (36)

SYMBOL	DESCRIPTION
M	F-CV4.0? x 4C, F-CV1.5? x 3C, FTP CABLE 0.5? x 4C (36) FLAT CABLE VCT-F4.0? x 4C - 15M FLAT CABLE FTP CABLE 0.5? x 4C - 15M
A	HIV4.0sq x 8 BELDEN CABLE #829 x 2LINE]-(28) HIV2.5sq x 4 FTP CABLE #E0.5sq x 4C - 3LINE]-(28)
B+ (A)	HIV4.0? x 156, E-FGV2.5? x 18 F-CV4.0? x 4C, F-CV1.5? x 3C (36)-12LINE FTP CABLE 0.5? x 4C CV4.0? x 4C, F-CV1.5? x 3C-10LINE BELDEN CABLE #829 x 8LINE DUCT 300 x 100 HIV4.0sq x 3 BELDEN CABLE #829 x 2LINE]-(28) HIV2.5sq x 4 FTP CABLE #E0.5sq x 4C - 3LINE]-(28)) x 2
C	HIV4.0sq x 6, E-FGV2.5sq x 1 (28C)
D	HIV4.0sq x 2, E-FGV2.5sq x 1 (18C)

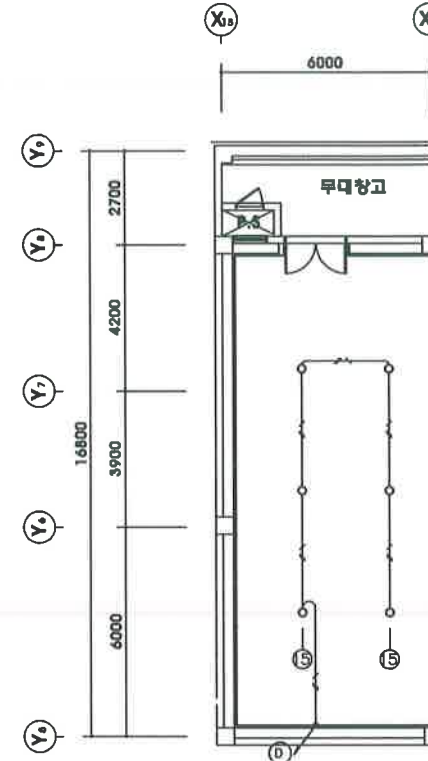

GRID IRON 상부레벨

PIPING & WIRING(퍼포먼스)

SCALE : 1/75

NOTE

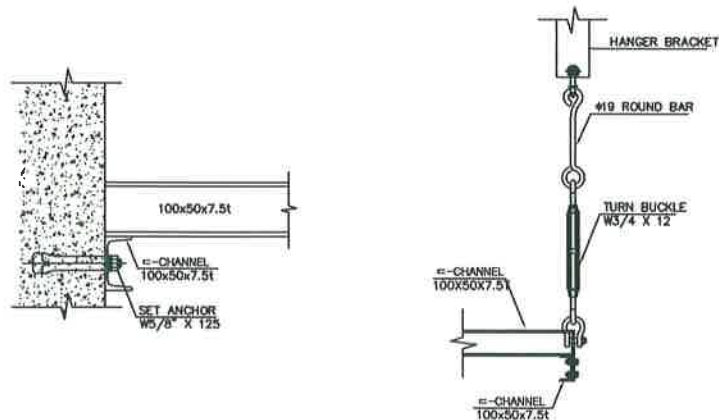
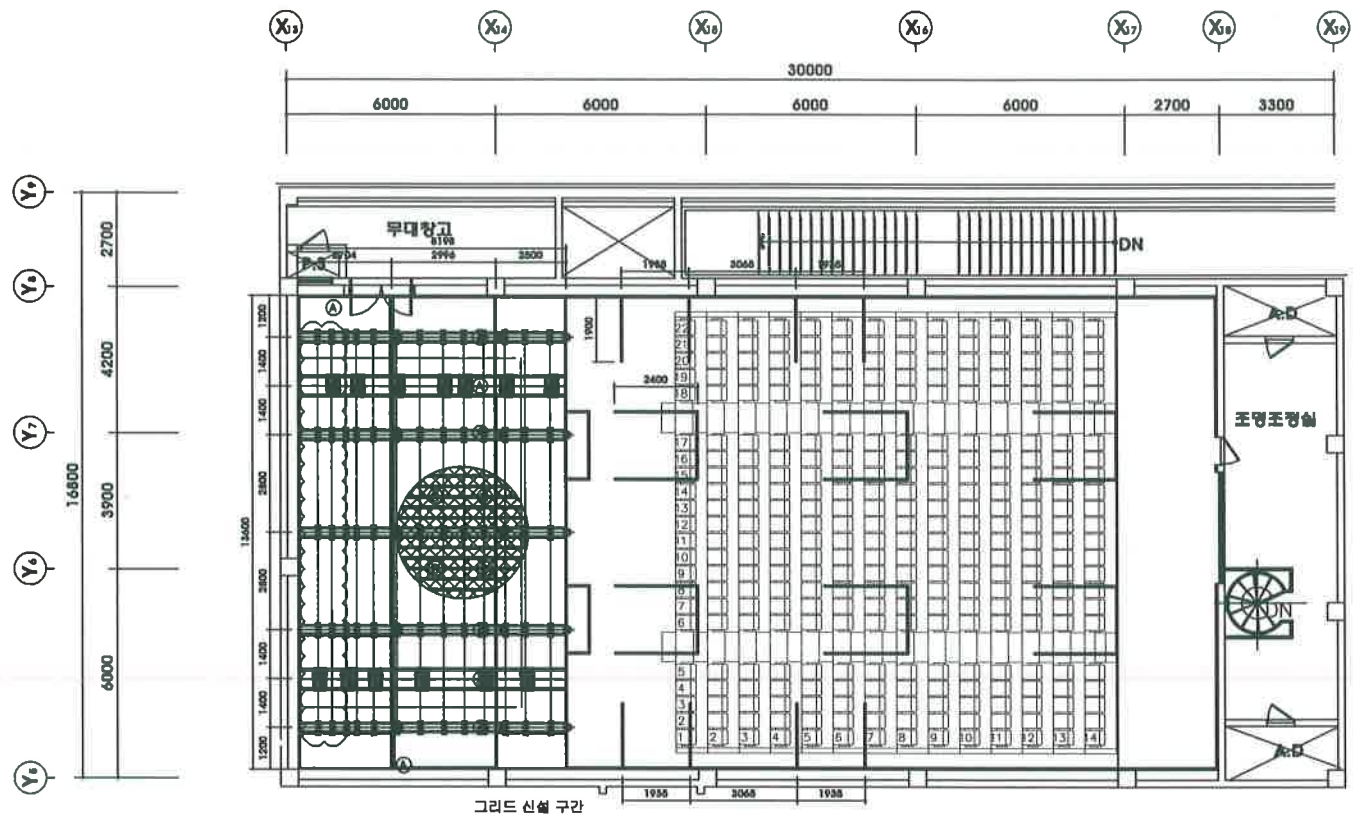

NO	DESCRIPTION	SPECIFICATION	REMARK
(A)	CHANNEL	100 x 50 x 7.5t	
(B)	PIPE	60x60x2.3t	EX METAL 지지용
	EX-METAL	SS #243	방청용
	HANGER POINT		

GRID IRON & 구동부 및 활차 배치도(퍼포먼스층)

SCALE : 1/75

NO	DESCRIPTION	DATE	APPROVED
----	-------------	------	----------

REVISIONS

Architect

PROJECT TITLE : 서울특별시

품의물아르센터 무대기계장치
구배 및 설치

SUB TITLE

NAME OF DRAWING : 01.01.01

GRID IRON &
구동부 및 활차 배치도(퍼포먼스층)

DATE : 2018/01/

SCALE : A1: 1/75
A3: 1/150

CHECKED BY : 01.01.01

APPROVED BY : 01.01.01

DRAWING NO. : 01.01.01

01-004

NOTE
(? ?)

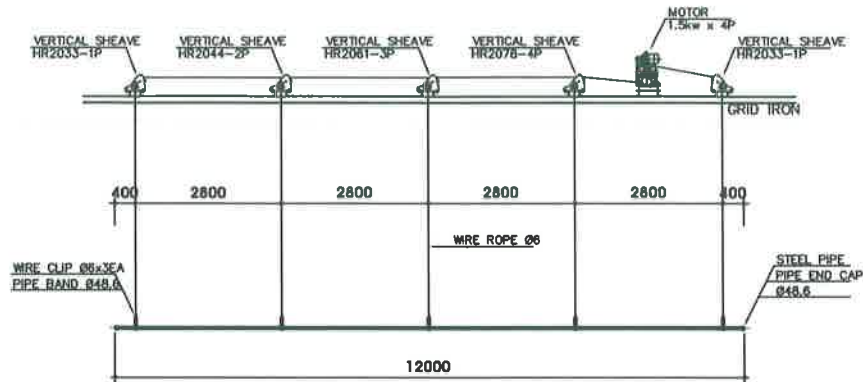

NO	DESCRIPTION	SPECIFICATION	QUANTITY	POWER	CAPACITY (kw)	REMARKS
①	PLACARD BATTEN	12,000L	1 SET	1.5kw X 4P	1.5	
⑤	FLAG BATTEN	12,000L	1 SET	1.5kw X 4P	1.5	

PLACARD & FLAG BATTEN
SCALE : 1/50

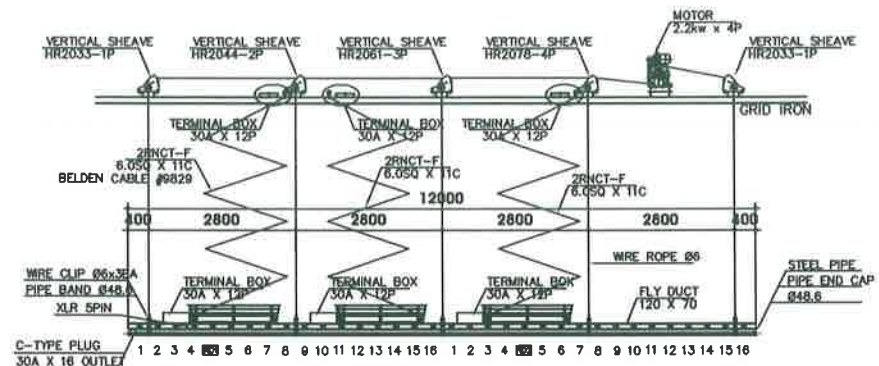

NO	DESCRIPTION	SPECIFICATION	QUANTITY	POWER	CAPACITY (kw)	REMARKS
②	NO.1~2 SUS LIGHT BATTEN	12,000L	2 SET	2.2kw X 4P	4.4	
④	NO.3 SUS LIGHT BATTEN	12,000L	1 SET	2.2kw X 4P	2.2	

NO.1~3 SUS LIGHT BATTEN
SCALE : 1/50

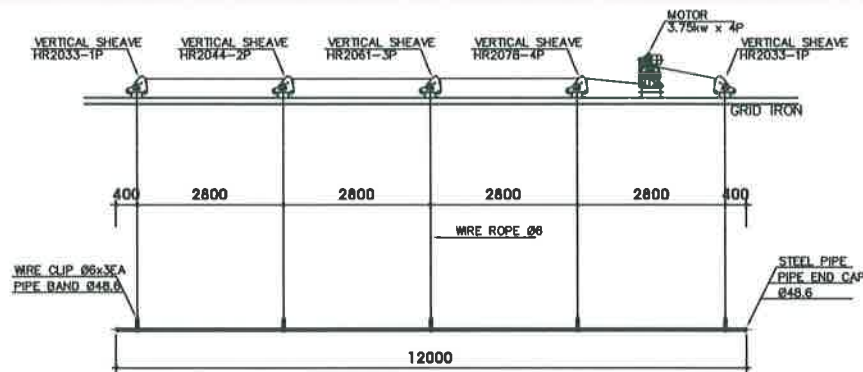

NO	DESCRIPTION	SPECIFICATION	QUANTITY	POWER	CAPACITY (kw)	REMARKS
③	NO.1~6 SET BATTEN	12,000L	6 SET	3.75kw X 4P	22.5	
⑩	HORIZONT CURTAIN	12,000L	1 SET	1.5kw X 4P	1.5	

NO.1~6 SET BATTEN
SCALE : 1/50

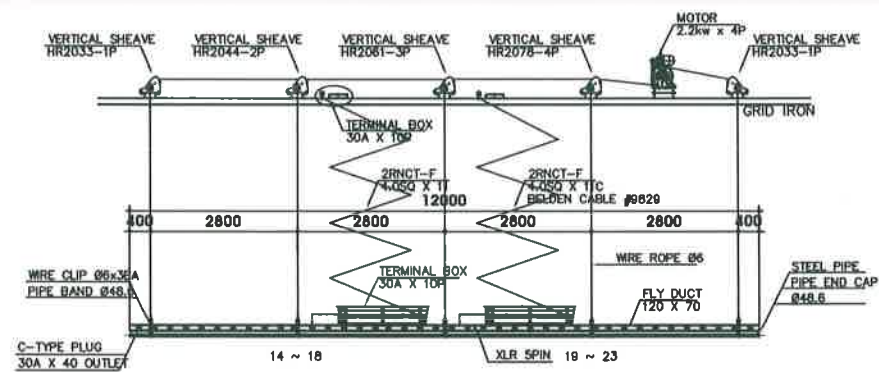

NO	DESCRIPTION	SPECIFICATION	QUANTITY	POWER	CAPACITY (kw)	REMARKS
④	UPPER LIGHT BATTEN	12,000L	1 SET	2.2kw X 4P	2.2	
	FLY DUCT	C-TYPE 30A X 40 OUT	1 SET			XLR SPIN 추가
	UPPER LIGHT	HL 500W	40 SET		20	

UPPER LIGHT BATTEN
SCALE : 1/50

NO. 1000 DESCRIPTION 1200 DATE 2018/01/01 APPR. 승인

REVISIONS

Author

PROJECT TITLE: 서울특별시
공익시설터스트터 무대기계장치
구매 및 설치

SUB TITLE

NAME OF DRAWING: 도면명
BATTEN DETAIL (바포먼스)

DATE 일자
2018/01/01
SCALE 축척
A1: 1/50
A3: 1/100
DRAWN BY 제도
APPROVED BY 승인

DRAWING NO. 도면번호

DF-005

NOTE

(? ?)

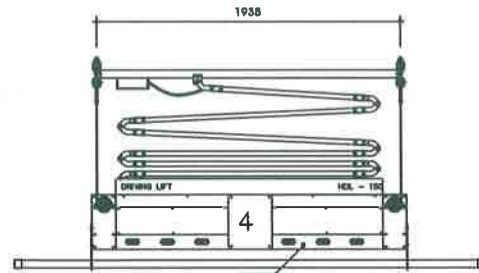

NO.1 DRIVING LIFT	24	24	25	25
NO.2 DRIVING LIFT	26	26	27	27
NO.3 DRIVING LIFT	28	28	29	29
NO.4 DRIVING LIFT	30	30	31	31

NO	DESCRIPTION	SPECIFICATION	QUANTITY	POWER	CAPACITY (kw)		REMARKS
					MACHINE	LIGHT	
⑥	NO.1~4 DRIVING LIFT	3,000L, HDL-150	4 SET	0.75kw X 4P	3		
		C-TYPE 30A X 6 OUT, XLR 5PINSET					

NO.1~4 DRIVING LIFT

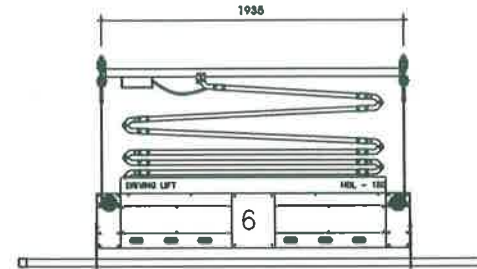

NO.5 DRIVING LIFT	32	32	33	33	34	34
NO.6 DRIVING LIFT	35	35	36	36	37	37

NO	DESCRIPTION	SPECIFICATION	QUANTITY	POWER	CAPACITY (kw)		REMARKS
					MACHINE	LIGHT	
⑦	NO.5~6 DRIVING LIFT	3,000L, HDL-150	2 SET	0.75kw X 4P	1.5		
		C-TYPE 30A X 6 OUT	2 SET				

NO.5~6 DRIVING LIFT

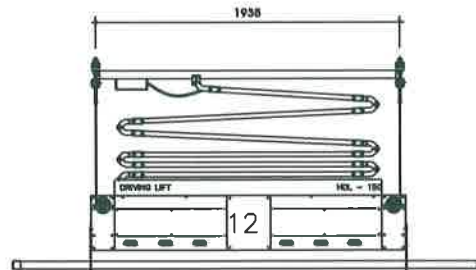

NO.7 DRIVING LIFT	38	38	39	39	40	40
NO.8 DRIVING LIFT	41	42	43	43	44	44
NO.9 DRIVING LIFT	45	45	46	46	47	47
NO.10 DRIVING LIFT	48	48	49	49	50	50
NO.11 DRIVING LIFT	51	51	52	52	53	53
NO.12 DRIVING LIFT	54	54	55	55	56	56

NO	DESCRIPTION	SPECIFICATION	QUANTITY	POWER	CAPACITY (kw)		REMARKS
					MACHINE	LIGHT	
⑧	NO.7~12 DRIVING LIFT	3,000L, HDL-150	6 SET	0.75kw X 4P	4.5		
		C-TYPE 30A X 6 OUT	6 SET				

NO.7~12 DRIVING LIFT

NO. 11.8 DESCRIPTION 1.8 DATE 11.8 11.8

REVISIONS

Author

PROJECT TITLE: 서울특별시

꿈의숲아르셀터 무대기계장치
구매 및 설치

SUB TITLE

NAME OF DRAWING: 리프트

DRIVING LIFT DETAIL &
CONTROL SYSTEM(파포인스)

DATE: 2018/01/

DESIGNED BY: 설계

SCALE: 1:1

APPROVED BY: 설계

APPROVED BY: 승인

DRAWING NO. 000000



NO	DESCRIPTION	SPECIFICATION	QUANTITY		CIRCUIT			MACHINE CAPACITY(kw)	LIGHT CAPACITY(kw)	REMARKS
			변경전	변경후	DIMMING	REMOTE DIRECT	DIRECT			
①	REAR GARD BATTEN	12,000L (1.5kw X 4P)	1 SET	4 SET				1.5		
②④	NO.1~3 SUSPENSION LIGHT BATT	212,000L (2.2kw X 4P)	2 SET	3 SET				4.4		SUSPENSION LIGHT BATTEN (1SET 4WHL LINE LOAD 100%)
	FET DUCT	C-TYPE 30A X 1/8 OUTLET, ALU-SW	2 SET	2 SET	7/14	7/12				
③	NO.1~6 SET BATTEN	12,000L (3.75kw X 4P)	5 SET	6 SET				15.0		SET BATTEN (1SET 4WHL)
⑤	UPPER LIGHT BATTEN	12,000L (2.2kw X 4P)	1 SET	1 SET				2.2		
	UPPER LIGHT FLY DUCT	C-TYPE 30A X 40 OUTLET L=12,000	1 SET	1 SET	10					
	UPPER LIGHT	HL 800W	40 SET	40 SET					20	
⑥	FLAG BATTEN(이탈스크림)	12,000L (1.5kw X 4P)	1 SET	1 SET				1.5		
⑦	NO.1~4 DRIVING LIFT	3,000L (HDL-150, 1.5kw X 4P), XLR	5th SET	4 SET	2/8	1/4		8		
⑧	NO.5~8 DRIVING LIFT	3,000L (HDL-150, 1.5kw X 4P)	2 SET	2 SET	3/6			3		
⑨	NO.9~12 DRIVING LIFT	3,000L (HDL-150, 1.5kw X 4P)	6 SET	6 SET	3/18			9		
⑩	NO.1~2 LEB CURTAIN	3,300W X 10,000L (MANUAL)	2 SET	2 SET						
⑪	HORIZONTAL BATTEN	12,000L (EHW45, 1.5kw X 4P)		1 SET				1.5		신설

SCALE : 1/100

SUB TITLE

NAME OF DRAWING: 351518

무대조명 배치도(퍼포먼스측)

DATE 필사
2018/01/

SCALE 比例
A1: 1/100
A2: 1/200

AS. 1/200
1998.01.01

UNIVERSITY NO. 26.10.12.18

DF-008

NOTE

NO. DATE DESCRIPTION NAME DATE NAME APPL. SIGN

REVISIONS

Author

PROJECT TITLE: 사립병원

공익시설아트센터 무대기계장치
구매 및 설치

BLU TITLE

NAME OF DRAWING: 도면명

조명배치도

DATE: 일자

2018/01/

DRAWN BY: 설계

SCALE: 축척

A1: CHECKED BY: 설계

A3: APPROVED BY: 승인

DRAWING NO. 도면번호

01-000

67500

13500

13500

13500

13500

6075

7425

조명디머실

DN

A.D

조명조정실

DN

A.D

47 47 46 46 45 45

53 53 52 52 51 51

25 25 27 27 26 26

31 31 RD4(2) 32 32

35 35 RD6(2) 36 36

39 39 40 40 41 41

28 28 29 29 30 30

33 33 RD3(2) 34 34

37 37 RD5(2) 38 38

42 42 43 43 44 44

48 48 49 49 50 50

54 54 55 55 56 56

7650

3500

7600

RD2 11 10 9 8 12 13 14

RD1 3 2 1 4 5 6 7

RD2 11 10 9 8 12 13 14 15 16 17 18 19 20 21 22 23 24 25 26 27 28 29 30 31 32 33 34 35 36 37 38 39 40 41 42 43 44 45 46 47 48 49 50 51 52 53 54 55 56

P.S